

SECTION A-A
W/ ECC. CONE

- NOTES:
1. ALL MANHOLES TO CONFORM TO ASTM C-478
 2. CONCRETE TO BE 4,500 PSI MINIMUM AT 28 DAYS
 3. BASE REINFORCED WITH #4 REBAR @ 12" O.C. EACH WAY
 4. RISER AND CONE SECTIONS REINFORCED WITH WELDED WIRE MESH
 5. MANHOLE OPENING IN CONE AND FLAT TOP IS 24" DIAMETER
 6. JOINTS SEALED WITH 1" JOINT SEALANT CONFORMING TO AASTHO M 198
 7. STEPS ARE REINFORCED POLYPROPYLENE @ 12" O.C.
 8. CAST IRON RING AND COVER TO BE APPROXIMATELY 400 LBS
 9. INVERT SHOWN IS IN SANITARY SEWERS ONLY. STORM SEWER MANHOLES HAVE NORMAL FLOOR
 10. FLAT TOP REINFORCING TO BE #4 @ 6" O.C. EACH WAY.

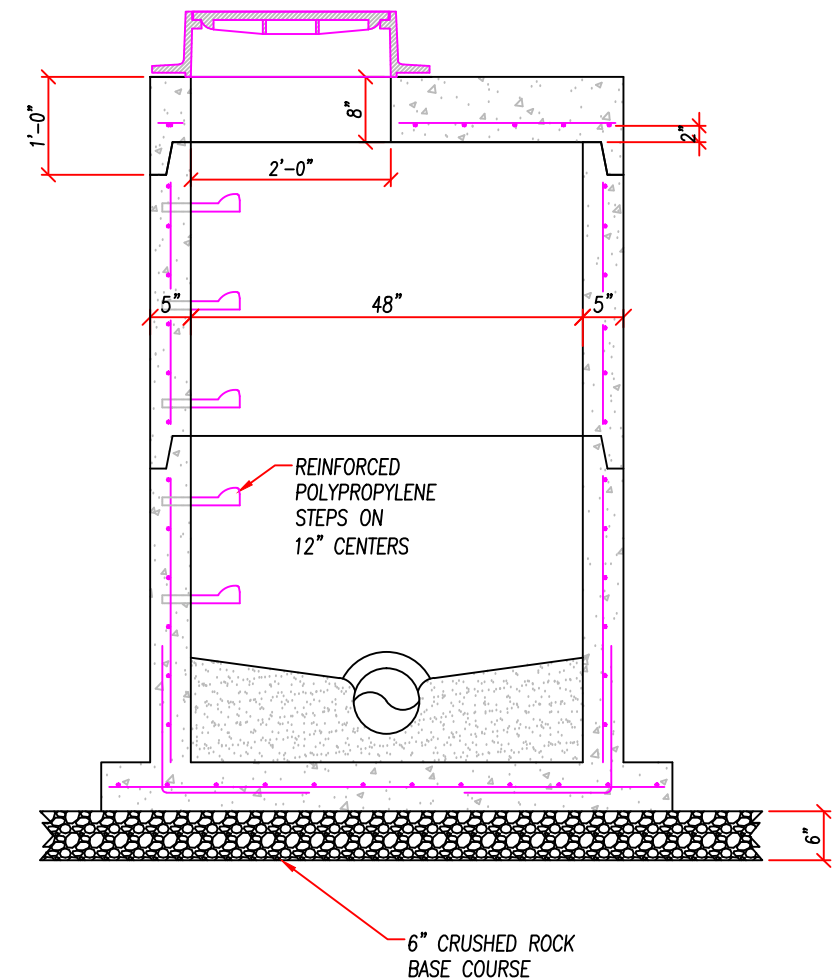

SECTION A-A
W/ FLAT TOP

48" DIAMETER PRECAST MANHOLE

PANHANDLE CONCRETE PRODUCTS, INC.

2202 WEST OVERLAND
SCOTT'S BLUFF, NEBRASKA 69361
PH: (508) 652-2161
FAX: (508) 652-2771

DRAWING NAME:
48" Ø MANHOLE

DATE:

REVISIONS

DRAWN/CHECKED BY:
AIH

SCALE:
NONE

DATE:
12-22-11

JOB NO.
XXX

DRAWING FILE:
48" MANHOLE SUBMITTAL

SHEET NO.

1 OF 1